

# HP-DT-FSR-MS

DATE	CHANGES	INTL	REV
06.27.13	Original	TH	1.0

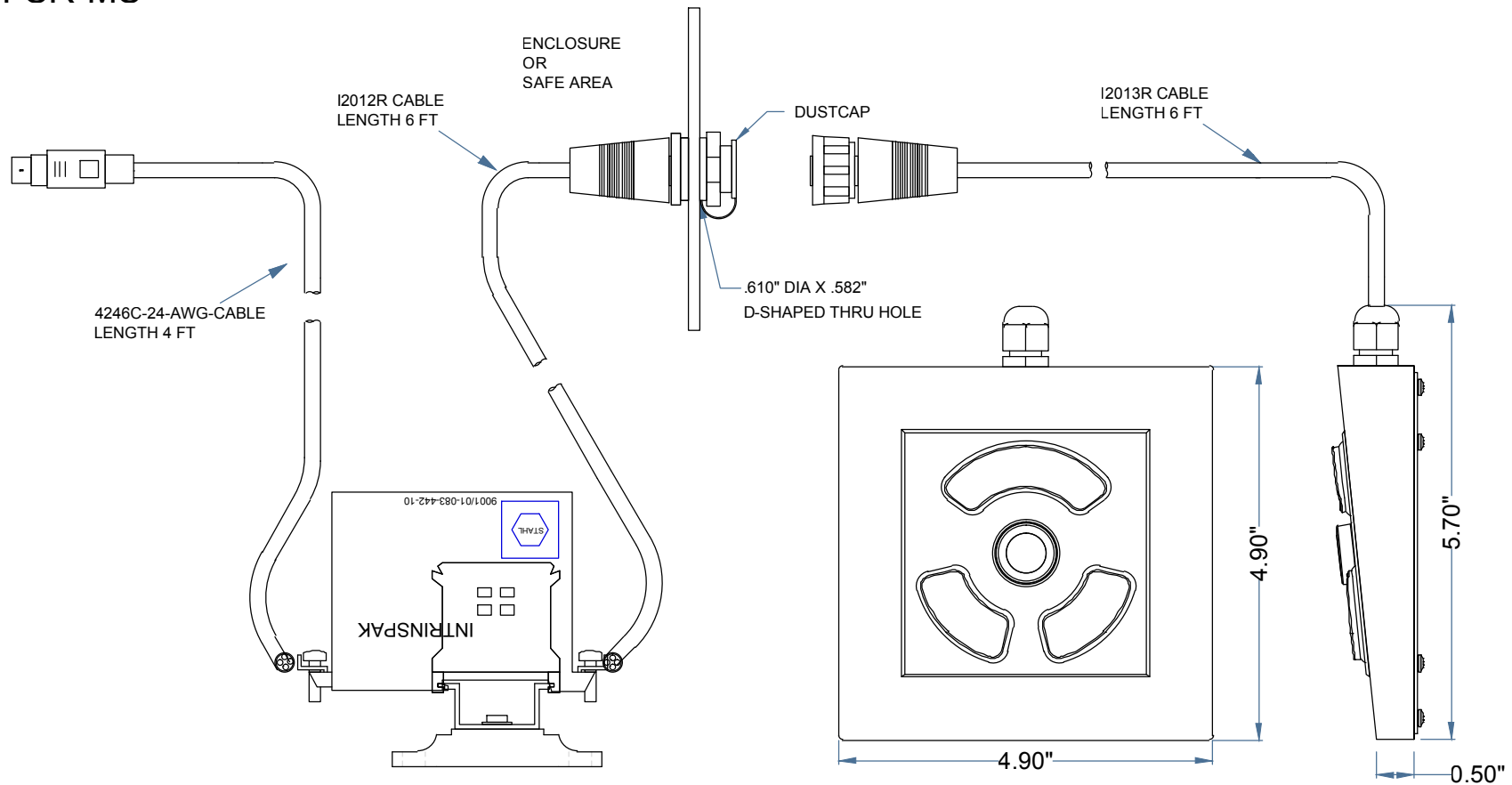

## KEY SWITCH

MATERIAL: Industrial Silicone Rubber  
 LIFE: Greater Than 10 Million Cycles  
 TRAVEL: 0.055 in.  
 ACTUATION FORCE: 5 oz. +/- 1.06oz (130g +/- 30g)  
 FEEDBACK: Tactile with Mechanical Snap

## POWER

MOUSE: 5V@10ma (from mouse connection port)

## HUMIDITY

100% Humidity Resistant

## TEMPERATURE RANGE

STORAGE: -40°F to +167°F (-40°C to +75°C)  
 OPERATING: -40°F to +158°F (-40°C to +70°C)

## FLAMMABILITY

PRINTED CIRCUIT BOARD: 94VO  
 SILICONE OVERLAY: 94HB  
 INTERFACE CABLE: 94VO

## VIBRATION

POWER SPECTRAL DENSITY: .04g<sup>2</sup>/HZ  
 FREQUENCY RANGE: 20Hz-2Khz  
 DURATION OF TEST PER AXIS: 3 hours

## SHOCK

3 X 11 ms pulses of 50g on each of 3 axis

## WEIGHT

1.25 lbs +/- 0.10 lbs (0.68 kg +/- 0.05 kg)

PROPRIETARY AND CONFIDENTIAL

DO NOT CHANGE WITHOUT APPROVAL OF MSHA



iKey, Ltd.  
 2621 Ridg epoint Dr. Suite 235  
 Austin, Texas 78754

©2012 iKey, Ltd.

Voice: (512) 837-0283  
 Fax: (512) 927-8530

Part Number: HP-DT-FSR-MS

Drawing Title: HP-DT-FSR-MS-MKT

Drawing Number: MKT0318

Revision: 1.0

Sheet: 1 OF 2

Date: 6.27.2013

TWH

# HP-DT-FSR-MS BARRIER

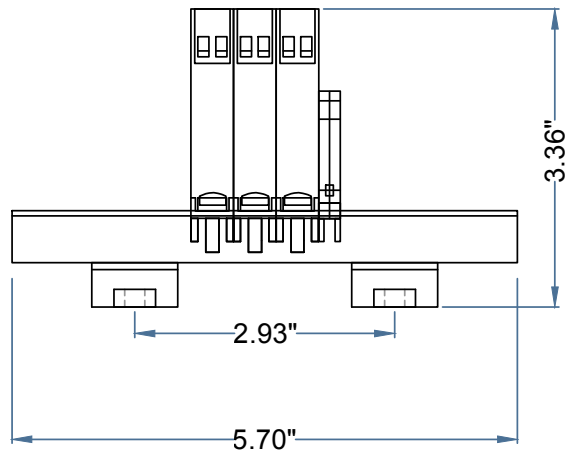
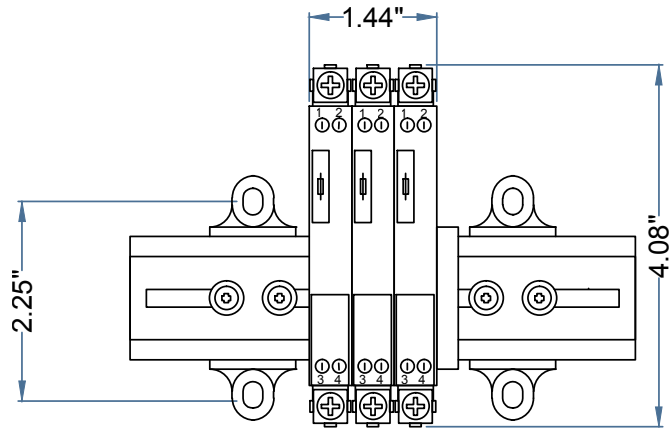

## Intrinsic Safety Barrier Specifications

STAHL#: 9001/01-083-442-10  
 Rated voltage 8.1 V  
 Internal Resistance 21 ohm

## Application Notes

1. Supply, clock and data leads to be wired through STAHL#: 9001/01-083-442-10 Intrinsic Safety Barrier as shown above.
2. Stahl Barriers must be housed in an MSHA-certified explosion-proof enclosure.
3. The IS barrier ground conductor must be greater than or equal to #12 AWG.
4. The grounding path resistance from the furthest IS barrier to the designated ground electrode must be less than 1 Ohm.
5. Shakeproof ground terminals must be used to connect the ground connector to designated ground electrode.
6. All ground path connections must be secure, identified, permanent, visible and accessible for routine inspection.
7. The barriers must not be connected to electrical equipment that uses or generates more than 250 volts rms.
8. The installation of the circuit shall preclude intermingling between intrinsically safe circuits, including their associated wires and cables and all other circuits, wires and cables.
9. There must be at least 2 inches of separation between the IS and non-IS wires on the barriers.

	PS/2 PIN NUMBER	SIGNAL	COLOR
MOUSE	1	DATA	BLACK
	3	GROUND	RED
	4	+5V	BROWN
	5	CLOCK	BLUE